

# APPENDIX 2: REVISED CABLE ROUTE

- NOTES:**
- 1 x P50 CONDUIT (NO SUBDUITS) USED UNLESS OTHERWISE NOTED (UNDERGROUND)
  - BOUNDARY TO BE LOCATED PRIOR TO CONSTRUCTION
  - CONDUIT DEPTH TO BE IN ACCORDANCE WITH OPTUS SPECIFICATIONS. ANY VARIATION IS TO BE NOTIFIED TO OPTUS PRIOR TO COMMENCEMENT OF CONSTRUCTION
  - SERVICES SHOWN ARE INDICATIVE ONLY. IT IS THE CONTRACTOR'S RESPONSIBILITY TO LOCATE ALL UTILITIES ACCURATELY PRIOR TO CONSTRUCTION
  - ALL RELEVANT PUBLIC AUTHORITIES ARE TO BE NOTIFIED PRIOR TO COMMENCEMENT OF ANY WORK
  - ALL AFFECTED PROPERTIES TO HAVE ACCESS MAINTAINED AT ALL TIMES
  - WHERE TREEMING OCCURS, COMPLY WITH GUIDELINES FOR TREEMING IN URBAN AREAS
  - BEFORE THE COMMENCEMENT OF ANY TRIMMING OF TREES, THE RELEVANT LOCAL COUNCIL IS TO BE NOTIFIED FOR APPROVAL AND/OR SUPERVISION PRIOR TO CONSTRUCTION
  - REFER TO ATTACHED SHEETS FOR SYMBOL LEGENDS AND ENVIRONMENTAL WORK METHOD DEFINITIONS
  - THE CONDUIT, SUBDUIT AND COVER INFORMATION HAS BEEN SUPPLIED BY THE CONTRACTOR AND/OR OPTUS
  - CONDUIT COVER LOCATIONS ARE INDICATIVE ONLY AND ARE TO BE USED AS A GUIDE. CARE SHOULD BE TAKEN WHEN WORKING IN PROXIMITY OF CONDUIT
  - REFER TO ROUTE OVERVIEW SHEET FOR LOCALITY
  - PITS AND POLES HAVE BEEN APPROXIMATELY LOCATED. THE UNDERGROUND CONDUIT HAS NOT BEEN LOCATED AND THE POSITION SHOWN IS INDICATIVE ONLY
  - CADASTRE COPYRIGHT OPTUS AND LAND & PROPERTY INFORMATION

SITE CODE: 2NZM  
 EQUIPMENT: FPP\_LGX-36  
 TERMINATION: G002.F02.030  
 CABLE MARKINGS:  
 SHEATH NAME: 2NZMBLS001  
 BUILDING ENTRY: -  
 TERMINATION: -  
 TO SPLICE: 22AJL12694

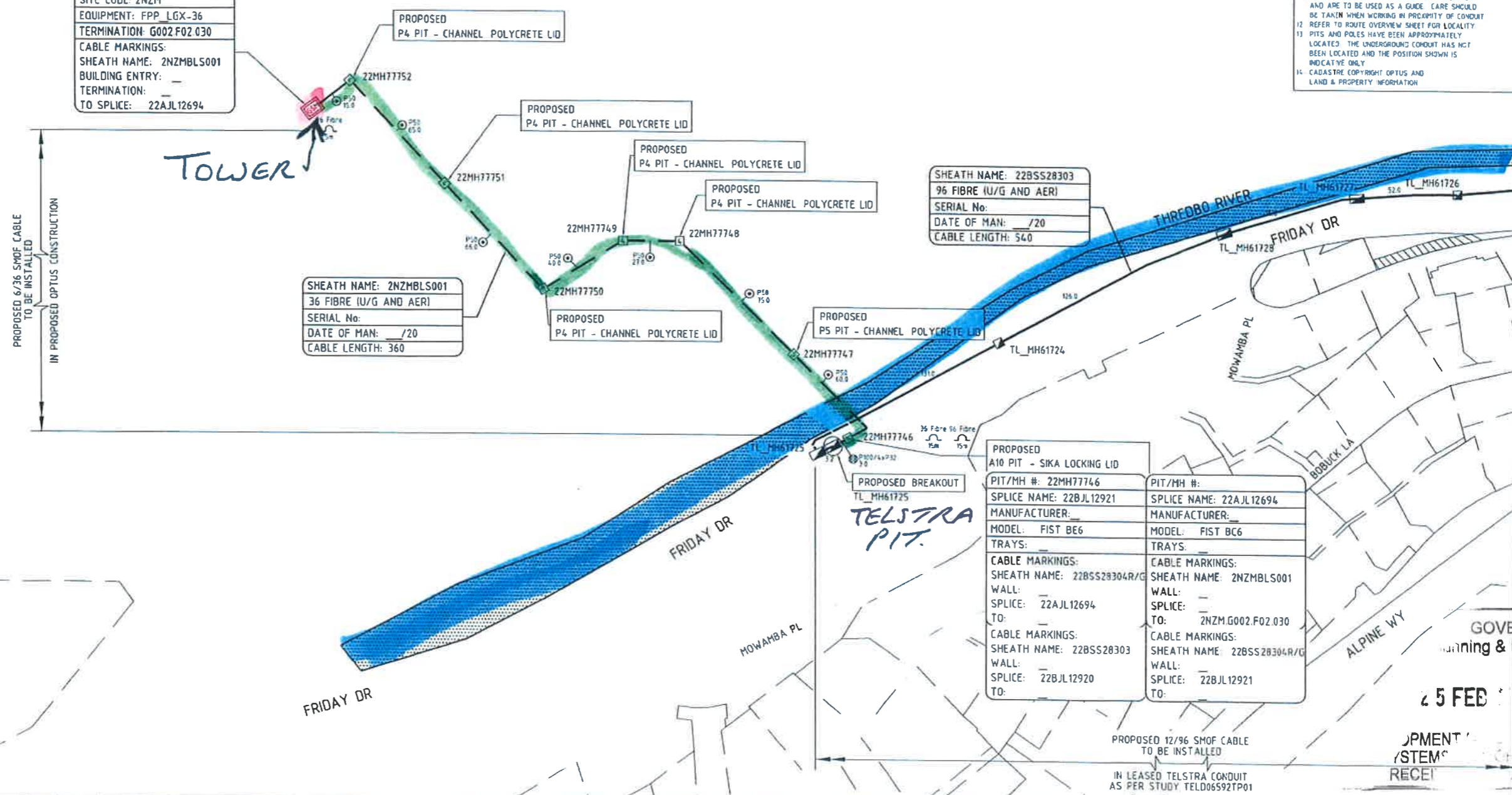

SHEATH NAME: 2NZMBLS001  
 36 FIBRE (U/G AND AER)  
 SERIAL No:  
 DATE OF MAN: /20  
 CABLE LENGTH: 360

SHEATH NAME: 22BSS28303  
 96 FIBRE (U/G AND AER)  
 SERIAL No:  
 DATE OF MAN: /20  
 CABLE LENGTH: 540

PROPOSED A10 PIT - SIKA LOCKING LID	
PIT/MH #: 22MH77746	PIT/MH #:
SPLICE NAME: 22BJL12921	SPLICE NAME: 22AJL12694
MANUFACTURER:	MANUFACTURER:
MODEL: FIST BE6	MODEL: FIST BC6
TRAYS:	TRAYS:
CABLE MARKINGS: SHEATH NAME: 22BSS28304R/G WALL: SPLICE: 22AJL12694 TO:	CABLE MARKINGS: SHEATH NAME: 2NZMBLS001 WALL: SPLICE: TO: 2NZM.G002.F02.030
CABLE MARKINGS: SHEATH NAME: 22BSS28303 WALL: SPLICE: 22BJL12920 TO:	CABLE MARKINGS: SHEATH NAME: 22BSS28304R/G WALL: SPLICE: 22BJL12921 TO:

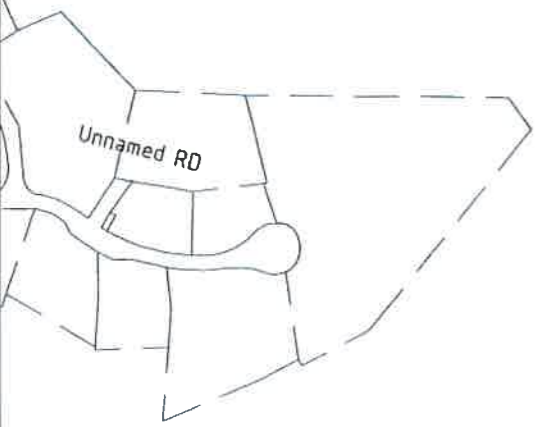

**OPTUS DISCLAIMER**  
 THIS DOCUMENT HAS BEEN PREPARED SOLELY FOR THE USE OF OPTUS NETWORKS PTY LTD (ACN 508 570 333) FOR USE IN MAINTAINING OPTUS FACILITIES. IT HAS NOT BEEN CREATED FOR ANY OTHER USE. IT SHOULD NOT BE USED TO LOCATE OPTUS ASSET. NO WARRANTY IS GIVEN THAT THE INFORMATION IS ACCURATE OR COMPLETE. IF YOU REQUIRE FURTHER INFORMATION REGARDING THE LOCATION OF AN OPTUS ASSET PLEASE PHONE 1822 505 333.

LOCATION OF UTILITIES ARE INDICATIVE ONLY. ACTUAL LOCATIONS MUST BE DETERMINED ON SITE BY THE UTILITY OWNER FOR THE CONTRACTOR.

REV	DATE	DESCRIPTION	DRAWN	APPROVED
PD	2001%	PRELIMINARY DRAWING ISSUE	SMC	JV
AMENDMENTS				

- SYMBOL LEGEND**
- CONDUIT - PROPOSED OPTUS CONSTRUCTION
  - CONDUIT - EXISTING
  - A- AERIAL STRAND (CATENARY WIRE)
  - DB DIRECT BURIED CABLE
  - P50 CONDUIT CONFIGURATION
  - PHOTO REFERENCE NUMBER REFER PHOTO PACK DOCUMENTATION

- OPTUS 5 PIT
- OPTUS 8 PIT
- OPTUS 9 PIT
- OPTUS 10 PIT
- OTHER UTILITY PIT
- OTHER UTILITY MANHOLE
- OTHER UTILITY MANHOLE BREAKOUT REQUIRED
- ENVIRONMENTAL NOTES REFER EWM SHEETS
- FIBRE TERMINATION POINT
- POWER POLE
- OPTUS MARKER POST
- FIBRE CABLE COIL
- FIBRE CABLE COIL LENGTH
- DEPTH OF COVER (m)
- CONDUIT OFFSET FROM PROPERTY LINE (m)

**OPTUS** *yes*

CONTRACTOR: **CS International**

YES OPTUS - FIBRE OPTIC CABLE PROJECTS

DRAWING TITLE: 001  
 002  
 003

DRAWING NO: 001  
 PROJECTED NO: --/E01866896  
 DUCT REFERENCE: TELD06592TP01  
 PROJECTED NO: --/E01866896  
 DUCT REFERENCE: TELD06592TP01  
 PROJECTED NO: --/E01866896  
 SCALE: 1:2000  
 SHEET NO: 003  
 REV: PD

GOVERNMENT  
 Planning & Infrastructure  
 25 FEB  
 RECEIVED  
 PERFORMANCE  
 BYNE